

# Thermoelectric Cooler

User's manual

EN



**SENCOR®**

SCM 4800BL

Prior to using this appliance, please read the user's manual thoroughly, even in cases, when one has already familiarised themselves with previous use of similar types of appliances. Only use the appliance in the manner described in this user's manual. Keep this manual for future use.

Save the original shipping box, packaging material, purchase receipt and warranty card for the duration of the warranty.

EN-1

## CONTENTS

IMPORTANT SAFETY INSTRUCTIONS . . . . .	3
DESCRIPTION OF THE TRAVEL COOLER. . . . .	5
OPTIONS FOR FASTENING THE TRAVEL COOLER IN A CAR . . . . .	6
BEFORE FIRST USE . . . . .	6
INTENDED APPLICATIONS AND OPERATION OF THE TRAVEL COOLER. . . . .	7
TROUBLESHOOTING. . . . .	8
CLEANING AND MAINTENANCE . . . . .	9
TECHNICAL SPECIFICATIONS . . . . .	9
INSTRUCTIONS AND INFORMATION REGARDING THE DISPOSAL OF USED PACKAGING MATERIALS . . .	10
DISPOSAL OF USED ELECTRICAL AND ELECTRONIC APPLIANCES . . . . .	10

## IMPORTANT SAFETY INSTRUCTIONS

- This appliance may be used by children 8 years of age and older and by persons with physical or mental impairments or by inexperienced persons if they are properly supervised or have been informed about how to use of the appliance in a safe manner and understand the potential dangers. Cleaning and maintenance must not be performed by children unless they are older than 8 years of age and under supervision.
- Do not allow children to play with the appliance.

## IMPORTANT SAFETY INSTRUCTIONS READ CAREFULLY AND STORE FOR FUTURE USE.

- The appliance can be used at home, in the office and similar workplaces, in the car, caravan, on a boat or when camping. However, it must not be exposed to rain.
- The appliance may only be powered using a safe small voltage corresponding to the designation on the rating label of the appliance.
- The power cord of this appliance can only be connected to a 12V socket of the corresponding shape (e.g. car cigarette lighter) or it can be connected using a voltage converter connected to a 220–240 V mains socket. In order to use 220–240 V mains power, use voltage converter model number Y50 U Sensor (not included). To purchase it, please contact your vendor.



### Attention:

Before you connect the appliance to a 220–240 V power socket on a boat, make sure that the socket is equipped with a residual current device. Otherwise there is a danger of injury.

- Keep the 12V socket (cigarette lighter) clean. When cleaning power sockets do not use metal or other conductive items.
- Do not use the appliance in very dusty or humid rooms such as laundries or bathrooms, in areas where chemicals are stored or in industrial surroundings.
- Do not place the appliance in the vicinity of an open flame or appliances that are sources of heat.
- Do not expose the appliance to direct sunlight.
- Make sure that the ventilation openings of the device are not covered during operation and that there is sufficient air circulation around the appliance.
- In the food storage area of the appliance, do not use any electrical devices or store any solvents or explosive substances such as sprays containing flammable propulsive gases.
- Do not fill the appliance with ice and do not pour liquids into it.
- Do not submerge the appliance in water or in any other liquid.
- Do not leave the appliance without supervision when it is connected to an el. power source.
- Always disconnect the appliance from the power socket if you will not be using it or before moving and cleaning it.
- Do not disconnect the appliance from the el. power source by pulling on the power cord. This could damage the power cord or the socket. Disconnect the cord from the power socket by gently pulling the plug of the power cord.
- Make sure the power cord is not touching a hot surface.
- It is forbidden to use the appliance if it has a damaged power cord or plug. If the power cord is damaged, please contact an authorised service centre to have it replaced.
- Do not use the appliance if it is not working correctly, if it has been damaged or has been submerged in water. Have all repairs or adjustments of the appliance performed at an authorised service centre. Tampering with the appliance during the warranty period may void the warranty policy.
- The manufacturer is not responsible for damages or injuries arising from the incorrect use or unqualified handling of this appliance.

# Thermoelectric Cooler

SCM 4800BL

EN

## DESCRIPTION OF THE TRAVEL COOLER

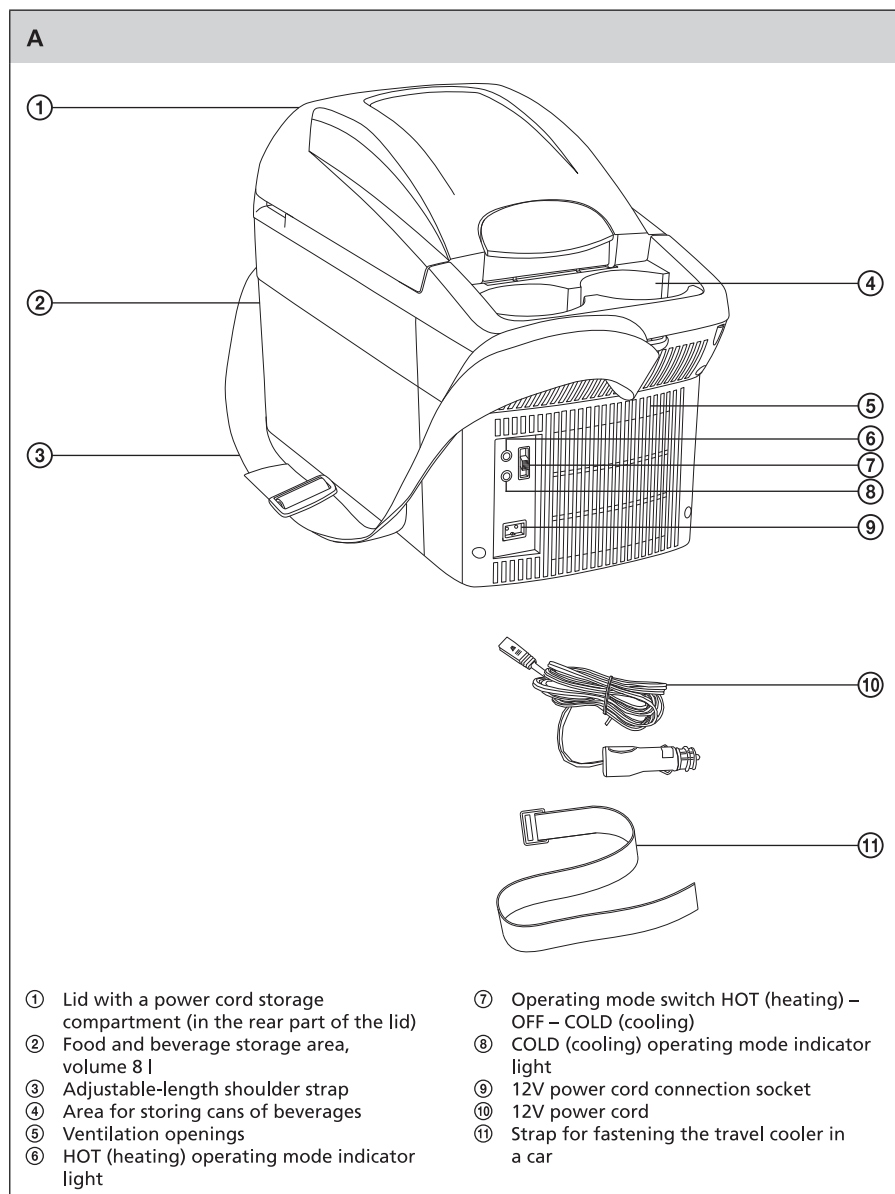

EN-5

## OPTIONS FOR FASTENING THE TRAVEL COOLER IN A CAR

### B



1. Fastening between the rear seats using the supplied strap A①.



2. Fastening to the front passenger seat using a 3-point car safety belt.



3. Fastening to the middle rear seat using a 2- or 3-point car safety belt.

## BEFORE FIRST USE

- Before first using the travel cooler, wipe the inner side of the lid A① and the food and beverage storage area A② using a sponge lightly dampened in a weak solution of water and neutral kitchen detergent. Use a sponge dampened in warm water to wipe the surface on to which you applied the detergent. Then thoroughly dry all parts.
- Anchor the free end of the chain as shown below. The chain limits the maximum extent to which the lid A① can be opened.

### C

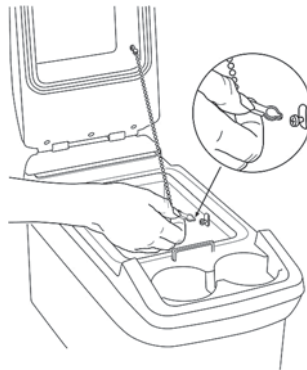

## INTENDED APPLICATIONS AND OPERATION OF THE TRAVEL COOLER

1. This travel cooler is used for cooling food and beverages or for keeping them warm. Likewise, it can be used as storage space for cups, mugs, etc. The cooling and heating principle is based on the so-called Peltier effect, where electrical energy is converted into thermal energy.
2. Open lid A①. Check that the inner space of the travel cooler A② is clean and dry and place your food and beverages inside. Place food and beverages into the travel cooler in their original packaging or in other packaging or containers.
3. Properly close the lid A① and located the travel cooler within range of an el. power supply. Select a well ventilated location to prevent the accumulation of heat around the appliance. Otherwise, effective operation cannot be guaranteed.
4. Take the power cord A⑩ out of compartment in the lid A① and connect it to the socket A⑨.
5. Connect the plug of the 12V power cord A⑩ to the 12V power socket (cigarette lighter) or the socket of a voltage converter (not included), which is then connected to a 220–240V alternating current socket.  
Use switch A⑦ to select the cooling (COLD) or heating (HOT) mode. The fact that an operating mode is running is indicated by the respective indicator light A⑥ or A⑧. In cars where it is possible to power the appliance from a 12V power socket without the car engine running, regularly check the battery power level to avoid it from going completely flat.

### Cooling mode (COLD)

To achieve effective cooling, insert food and beverages into the travel cooler that are pre-cooled. Cooling warm food and beverages will take a longer period of time. The maximum cooling capacity of this travel cooler is 20 °C below the ambient temperature.



#### Attention:

If you wish to use the travel cooler for cooling medication, first make sure that the cooling capacity is sufficient for the given medication.

### Heating mode (HOT)

The heating mode is primarily intended for keeping heated food and beverages warm. Heated food and beverages will remain warm for several hours even after the travel cooler is turned off, under the condition that the lid A① remains properly shut.

If you wish to heat cold food and beverages in the travel cooler, it is necessary to expect a longer heating time. The maximum heating capacity is 65 °C.



#### Note:

The storage space for cans of beverages A④ is without a cooling/heating effect.

6. To stop the operation of the travel cooler, set the switch A⑦ to the OFF position. Disconnect the power cord A⑩ from the el. power source.

# Thermoelectric Cooler

SCM 4800BL

## TROUBLESHOOTING

Defect description	Possible cause	Possible solution
The travel cooler doesn't work. The fan on the front panel of the travel cooler is not turning.	The is no power in the 12V power socket (cigarette lighter).	In most types of vehicles the ignition must be turned on for the cigarette lighter to be powered with electrical power.
	There is no electrical power in the power socket where the travel cooler is plugged in via a residual current device.	Try connecting the travel cooler to a different power socket.
The ignition is turned on but the travel cooler does not work.	The cigarette lighter has cigarette ash inside.	Disconnect the power cord plug from the cigarette lighter. Turn off the ignition and thoroughly clean out the cigarette lighter and the power cord plug if it was soiled by the cigarette lighter. Turn on the ignition and try to reinsert the power cord plug into the cigarette lighter.
	The 12V fuse of the power plug is burned out.	It is necessary to replace the 5A fuse in the 12V power plug.
	The fuse of the cigarette lighter is burned out.	It is necessary to replace the fuse in the cigarette lighter. Follow the instructions in your vehicle's user's manual.
The travel cooler is not cooling sufficiently. The fan on the front panel of the travel cooler is not rotating.	The fan motor may be damaged.	This defect must be remedied by an authorised service centre.
The travel cooler is not cooling sufficiently. The fan on the inner side of the lid is not rotating.	The fan motor may be damaged.	This defect must be remedied by an authorised service centre.
The travel cooler is not cooling sufficiently. Both the internal and external fan is rotating.	The thermoelectric element may be damaged.	This defect must be remedied by an authorised service centre.

# Thermoelectric Cooler

SCM 4800BL

EN

## CLEANING AND MAINTENANCE

- Before cleaning, disconnect the power cord A<sup>10</sup> from the el. power supply and from the connection socket A<sup>9</sup> in the travel cooler.
- Keep the travel cooler clean. Regularly clean it with a sponge dampened in clean water or a solution of kitchen detergent and water in the event that it is more dirty. Use a sponge dampened in warm water to wipe the surface on to which you applied the detergent. Then dry everything thoroughly. Make sure that when cleaning, no water leaks into the ventilation holes.
- Do not use steel wool, abrasive cleaning agents, petrol, thinners, etc. This could damage the surface of the travel cooler. Do not submerge the travel cooler under water, do not wash it under running water or in a dishwasher.

## TECHNICAL SPECIFICATIONS

Nominal voltage.....	12 V
Rated power input.....	32 W
Maximum cooling capacity.....	20 °C below the ambient temperature
Maximum heating capacity .....	65 °C
Climatic class.....	N (moderate temperature, ambient temperature range of 16–32 °C)
Insulation.....	expanded polystyrene foam (EPS)
Volume.....	8 l
Dimensions (w x h x d).....	20 x 30 x 44 cm
Weight .....	3.1 kg

e 4

This travel cooler is approved for use in vehicles in accordance with EU directives.

We reserve the right to change text and technical specifications.

## INSTRUCTIONS AND INFORMATION REGARDING THE DISPOSAL OF USED PACKAGING MATERIALS

Dispose of packaging material at a public waste disposal site.

## DISPOSAL OF USED ELECTRICAL AND ELECTRONIC APPLIANCES



The meaning of the symbol on the product, its accessory or packaging indicates that this product shall not be treated as household waste. Please, dispose of this product at your applicable collection point for the recycling of electrical & electronic equipment waste. Alternatively in some states of the European Union or other European states you may return your products to your local retailer when buying an equivalent new product. The correct disposal of this product will help save valuable natural resources and help in preventing the potential negative impact on the environment and human health, which could be caused as a result of improper liquidation of waste. Please ask your local authorities or the nearest waste collection centre for further details. The improper disposal of this type of waste may fall subject to national regulations for fines.

### For business entities in the European Union

If you wish to dispose of an electrical or electronic device, request the necessary information from your seller or supplier.

### Disposal in other countries outside the European Union

If you wish to dispose of this product, request the necessary information about the correct disposal method from local government departments or from your seller.



This product meets all the basic EU regulation requirements that relate to it.

# CAMPINGAZ®

## Eurotransformer 230 V AC/12 V DC

(Ref. 203 164, 2000033075)

(Ref. 203 442, for UK\* only)

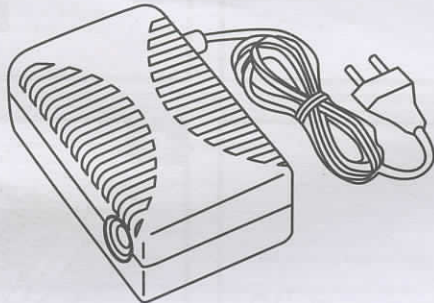

<b>GB</b> Instruction leaflet .....	1	<b>SI</b> Navodila za uporabo .....	7
<b>FR</b> Mode d'emploi .....	1	<b>SK</b> Návod na použitie.....	8
<b>DE</b> Bedienungsanleitung .....	2	<b>HU</b> Használati utasítás .....	8
<b>NL</b> Gebruiksaanwijzing .....	2	<b>LT</b> Naudojimo instrukcija .....	9
<b>IT</b> Libretto d'istruzioni .....	3	<b>LV</b> Lietošanas pamācība .....	9
<b>ES</b> Instrucciones de uso .....	3	<b>BG</b> Инструкция за употреба .....	10
<b>PT</b> Manual de instruções .....	4	<b>EE</b> Juhend.....	10
<b>CZ</b> Návod k použití.....	4	<b>GR</b> Οδηγίες χρήσης.....	11
<b>FI</b> Käyttöohje.....	5	<b>RO</b> Instrucțiuni de folosire .....	11
<b>DK</b> Betjeningsvejledning.....	5	<b>RU</b> инструкция по эксплуатации ...	12
<b>SE</b> Bruksanvisning .....	6	<b>HR</b> Brošura s uputama .....	12
<b>NO</b> Bruksanvisning .....	6	<b>TR</b> Talimat Kitapçığı .....	13
<b>PL</b> Instrukcja obsługi.....	7	<b>AE</b> طريقة الاستخدام.....	13

**Eurotransformer 230 V AC/12 V DC**

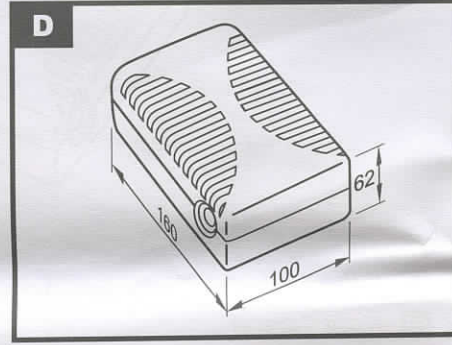
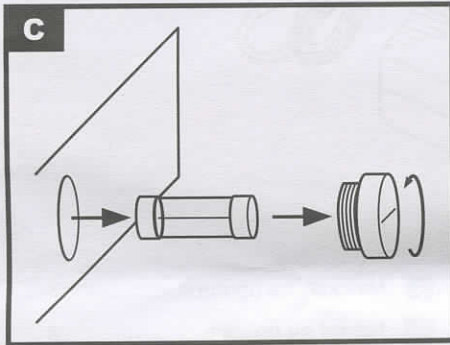
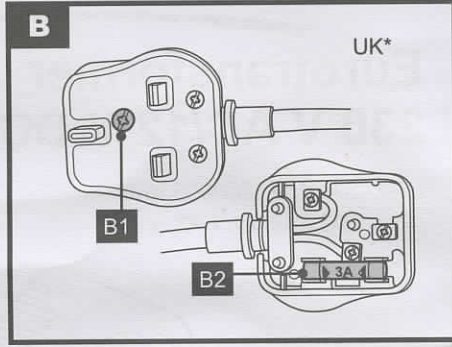
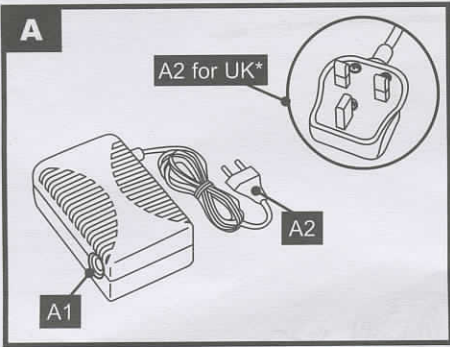

## GB - Instruction leaflet Eurotransformer 230 V AC/12 V DC

Thank you for choosing CAMPINGAZ®. We hope that you will be completely satisfied with transformer 230 V AC/12 V DC.  
CAREFULLY READ THE INSTRUCTION MANUAL BEFORE USE.

### 1. SAFETY

- This transformer can be used by children aged 8 years or older and persons with reduced physical, sensory or mental capabilities or lack of transformer-related experience and knowledge, only if they have been given supervision or instruction concerning use of the transformer in a safe way and understand the hazards involved. Children shall not play with the transformer. Cleaning and user maintenance shall not be done by children without supervision.
- IF THE TRANSFORMER IS RUNNING, KEEP IT AWAY FROM THE REACH OF CHILDREN.
- The transformer must always be in a horizontal position when in use.
- Never pour liquid into the ventilation openings of the transformer. Any splashing of water onto the electrical power supply may start a fire, causing injury to persons or damage to components.
- Never obstruct the ventilation openings of the transformer. It generates heat and needs good air circulation in order to work properly.
- Do not use the transformer if the connector, the cable or the transformer itself show signs of damage.

### 2. CONNECTION

Plug the equipment to be supplied with 12 V DC into the cigar-lighter connector of the transformer (diagram A1).  
Then connect the end of the cable from the transformer (diagram A2) to the 230 V AC- mains.

### 3. TROUBLESHOOTING GUIDE

#### 3.1. Fuses replacement

Your transformer is protected by an internal fuse (Drawing C) and by the fuse of the plug. After the disconnection of your device from the mains, first check that the plug fuse has not blown by unscrewing the plug (Drawing B1). Second check that the internal fuse has not blown by unscrewing the fuse holder (Drawing B2).

#### 3.2. Damaged cable

The power supply cable cannot be replaced. If it is damaged, the equipment must be discarded.

**NOTE:** For any other repairs, contact an approved repairer.

### 4. RECYCLING (DRAWING E)

This recycling symbol means that this appliance is subject to separate collection.

At the end of its useful life, the appliance must be disposed of correctly.

The appliance must not be disposed of with unsorted household wastes.

Do not dump, do not incinerate: the presence of certain hazardous materials in the electrical and electronic equipment may be harmful to the environment and have potential effects on human health.

If you wish to dispose of your appliance, please take it to a waste recovery centre designed for this purpose (drop-off centre).

Contact your local authorities for information.

Separate collection of waste favours reuse, recycling or other forms of recovery of recyclable materials contained in waste.

## FR - Mode d'emploi Eurotransformer 230 V AC/12 V DC

Nous vous remercions d'avoir choisi CAMPINGAZ®. Nous espérons que vous serez complètement satisfait de votre transformateur 230 V AC/12 V DC.  
LIRE ATTENTIVEMENT LA NOTICE AVANT UTILISATION

### 1. SECURITE

- Ce transformateur peut être utilisé par des enfants âgés d'au moins huit ans et par des personnes ayant des capacités physiques, sensorielles ou mentales réduites ou dénuées d'expérience ou de connaissance, si les personnes sont correctement surveillées ou si des instructions relatives à l'utilisation de l'appareil en toute sécurité leur ont été données et si les risques encourus ont été appréhendés. Les enfants ne doivent pas jouer avec le transformateur. Le nettoyage et l'entretien par l'utilisateur ne doivent pas être effectués par des enfants sans surveillance.
- SI LE TRANSFORMATEUR EST BRANCHÉ, TENEZ-LE HORS DE PORTÉE DES ENFANTS.
- L'appareil doit toujours fonctionner en position horizontale.
- Ne jamais verser de liquide dans les aérations de l'appareil. Toute projection d'eau sur l'alimentation électrique, pourrait provoquer un feu, causant ainsi des dommages corporels ou une détérioration des composants.
- Ne jamais obstruer les aérations de l'appareil car celui-ci produit de la chaleur. Il requiert donc une bonne circulation d'air pour pouvoir fonctionner convenablement.
- N'utiliser pas l'appareil si la prise, le cordon ou l'appareil lui-même présentent des signes de détérioration.

### 2. BRANCHEMENT

Brancher l'appareil à alimenter en 12 V DC à la prise allume cigare du transformateur (schéma A1). Puis raccorder l'extrémité du câble du transformateur (schéma A2) au secteur 230 V AC-.

### 3. DÉPANNAGE

#### 3.1. Remplacement du fusible

Votre appareil est protégé par un fusible sur le circuit primaire. Après avoir débranché votre appareil du secteur, vérifier que le fusible n'ait pas fondu en le retirant du porte fusible (schéma C).

#### 3.2. Câble endommagé

Le câble d'alimentation ne peut être remplacé. Si celui-ci est endommagé, il convient de mettre l'appareil au rebut.

**NOTA :** pour toutes autres réparations s'adresser à un réparateur agréé.

### 4. RECYCLAGE (SCHÉMA E)

Ce symbole de recyclage signifie que cet appareil fait l'objet d'une collecte sélective.

Au terme de sa durée de vie, l'appareil doit être correctement mis au rebut.

L'appareil ne doit pas être mis avec les déchets ménagers non triés.

Ne pas jeter dans la nature, ne pas incinérer :

la présence de certaines substances dangereuses dans les équipements électriques et électroniques peut être nuisible à l'environnement et avoir des effets potentiels sur la santé humaine.

Si vous souhaitez vous débarrasser de votre appareil, veuillez à le mettre dans un centre de valorisation des déchets spécialement prévu à cet effet (déchetterie).

Renseignez-vous auprès des autorités locales.

La collecte sélective de ces déchets favorisera la réutilisation, le recyclage ou autres formes de valorisation des matériaux recyclables contenus dans ces déchets.